

Industrial Shock Absorbers

YSRA series
Single acting
Fixed Damping

This are fixed damping single acting Hydraulic shock absorbers. These shock absorbers are designed to stop moving loads linearly with a counter force proportional to the speed of the impacting object striker cap



Performance

| Model No | Threading | Stroke in mm | Energy capacity per stroke N-M | Energy Capacity per Hour NM |
|-----------|------------|--------------|--------------------------------|-----------------------------|
| YSR-8-8 | M 12 x 1 | 10 | 5 | 16000 |
| YSR-12-12 | M 16 X 1 | 13 | 10 | 34000 |
| YSR-16-20 | M 22 X 1.5 | 20 | 50 | 60000 |
| YSR-20-25 | M 26 x1.5 | 25 | 80 | 90000 |

| | |
|------------------|--|
| Ordering Code | YSRmodel Name as above+MC /PU/NC MC =Metallic cap PU =Pu Cap NC =No Ca |
| Impact velocity- | 0.1 to 2.5M/Sec |
| Temprature Range | -10 to +80° C |
| Material | Housing-Steel coated with Anticorrosive Black finish Arcor finish Seals=Polyurethane End cap= Polyurethane or Metallic cap Rod= Hardchrome plated Ground and Polished In Built End stopper(Mechanical stop) Stainless Steels available |

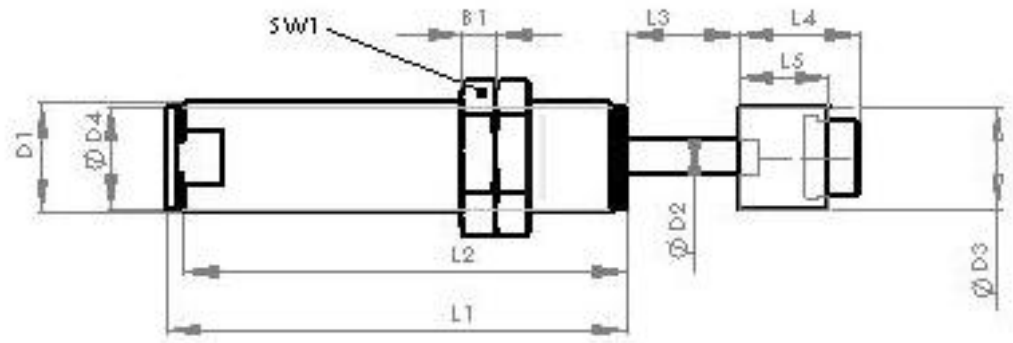

Dimensional Details

| Model No | B1 | D1 | D2 | D3 | D4 | L1 | L2 | L3 | L4 | L5 | Sw1 |
|-----------|----|------------|----|----|----|-----|----|----|----|----|-----|
| YSR-8-8 | 6 | M12 X 1 | 4 | 12 | 10 | 53 | 51 | 10 | 15 | 10 | 19 |
| YSR-12-12 | 6 | M16 X1 | 6 | 12 | 14 | 66 | 62 | 13 | 16 | 11 | 21 |
| YSR-16-20 | 6 | M22 X 1.5 | 6 | 18 | 20 | 82 | 78 | 20 | 22 | 16 | 27 |
| YSR-20-25 | 7 | M 26 X 1.5 | 8 | 18 | 22 | 106 | 98 | 25 | 20 | 16 | 30 |